

## Schijfhandwielen

Aluminium, kunststof bekleding

### SPECIFICATIE

#### Typen

- Type **A**: zonder handgreep
- Type **R**: met draaiende handgreep

#### Boringcodes

- Versie **B**: zonder spiebaan
- Versie **K**: met spiebaan

Aluminium

- Bewerkte naaf
- Gebogen rand
- Kunststof bekleding  
zwart, RAL 9005, textuurafwerking **SW**  
zilver, RAL 9006, textuurafwerking **SR**

Radiale en axiale uitloop van de rand < 0,4

Draaiende handgrepen GN 798.2 (zie pagina 578)

- Kunststof, technopolymeer  
Zwart, matte afwerking
- Spindel staal  
Verzinkt, blauw gepassiveerd

Draaiende cilindrische handgrepen GN 599.5

- Kunststof, technopolymeer  
Zwart, matte afwerking
- Spindel RVS AISI 303



reddot design award

### INFORMATIE

Schijfhandwielen GN 923 onderscheiden zich door hun moderne design.

De verwijderbare kunststof afdekking omhult de bevestigingscomponenten zoals verzonken sluitringen en uitstekende of verzonken assen.

### TOEBEHOREN

- Plat verzonken sluitringen GN 184 (zie pagina 971)

### TECHNISCHE INFORMATIE

- Spiebaan DIN 6885 (zie pagina A16)
- Kruisgaten GN 110 (zie pagina A17)
- Fundamentele ISO-toleranties (zie pagina A21)

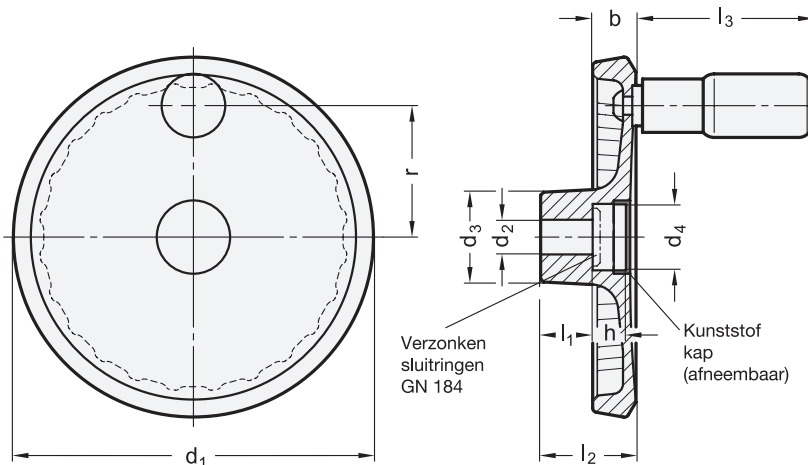

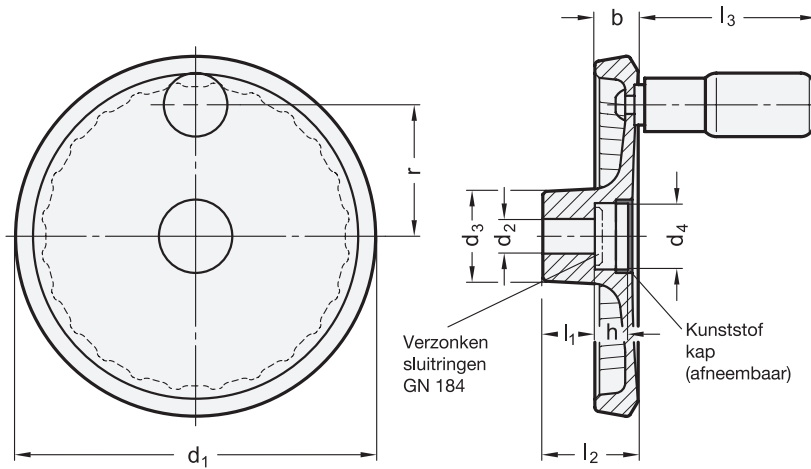

\* Compleet met kleurindex van de Schijfhandwielen (SW or SR)

**SW** RAL9005 **SR** RAL9006

GN 923-A

| Beschrijving       | d1  | d2 H7 Boring | d3 | d4   | b    | h    | l1 | l2 ≈ | l3 ≈ | r    | Ø Handgreep GN 798.2 | Ø Handgreep GN 599.5 | aanbevolen verzonken sluitring | ⚖   |
|--------------------|-----|--------------|----|------|------|------|----|------|------|------|----------------------|----------------------|--------------------------------|-----|
| GN 923-50-B6-A-*   | 50  | 6            | 20 | 13   | 13   | 7    | 16 | 26   | 20   | 16   | -                    | 13                   | GN 184-12                      | 66  |
| GN 923-50-K6-A-*   | 50  | 6            | 20 | 13   | 13   | 7    | 16 | 26   | 20   | 16   | -                    | 13                   | GN 184-12                      | 66  |
| GN 923-50-B8-A-*   | 50  | 8            | 20 | 13   | 13   | 7    | 16 | 26   | 20   | 16   | -                    | 13                   | GN 184-12                      | 65  |
| GN 923-50-K8-A-*   | 50  | 8            | 20 | 13   | 13   | 7    | 16 | 26   | 20   | 16   | -                    | 13                   | GN 184-12                      | 65  |
| GN 923-63-B8-A-*   | 63  | 8            | 23 | 17   | 13   | 7    | 16 | 26   | 20   | 20.5 | -                    | 13                   | GN 184-16                      | 103 |
| GN 923-63-K8-A-*   | 63  | 8            | 23 | 17   | 13   | 7    | 16 | 26   | 20   | 20.5 | -                    | 13                   | GN 184-16                      | 103 |
| GN 923-63-B10-A-*  | 63  | 10           | 23 | 17   | 13   | 7    | 16 | 26   | 20   | 20.5 | -                    | 13                   | GN 184-16                      | 102 |
| GN 923-63-K10-A-*  | 63  | 10           | 23 | 17   | 13   | 7    | 16 | 26   | 20   | 20.5 | -                    | 13                   | GN 184-16                      | 102 |
| GN 923-80-B10-A-*  | 80  | 10           | 26 | 17   | 13   | 7    | 16 | 26   | 43.5 | 27.5 | 16                   | -                    | GN 184-16                      | 101 |
| GN 923-80-K10-A-*  | 80  | 10           | 26 | 17   | 13   | 7    | 16 | 26   | 43.5 | 27.5 | 16                   | -                    | GN 184-16                      | 101 |
| GN 923-80-B12-A-*  | 80  | 12           | 26 | 17   | 13   | 7    | 16 | 26   | 43.5 | 27.5 | 16                   | -                    | GN 184-16                      | 100 |
| GN 923-80-K12-A-*  | 80  | 12           | 26 | 17   | 13   | 7    | 16 | 26   | 43.5 | 27.5 | 16                   | -                    | GN 184-16                      | 100 |
| GN 923-100-B10-A-* | 100 | 10           | 28 | 22   | 14   | 9.5  | 17 | 30   | 58   | 36   | 18                   | -                    | GN 184-20                      | 153 |
| GN 923-100-K10-A-* | 100 | 10           | 28 | 22   | 14   | 9.5  | 17 | 30   | 58   | 36   | 18                   | -                    | GN 184-20                      | 153 |
| GN 923-100-B12-A-* | 100 | 12           | 28 | 22   | 14   | 9.5  | 17 | 30   | 58   | 36   | 18                   | -                    | GN 184-20                      | 152 |
| GN 923-100-K12-A-* | 100 | 12           | 28 | 22   | 14   | 9.5  | 17 | 30   | 58   | 36   | 18                   | -                    | GN 184-20                      | 152 |
| GN 923-125-B12-A-* | 125 | 12           | 31 | 22   | 15   | 11   | 18 | 33   | 61   | 45.5 | 22                   | -                    | GN 184-20                      | 253 |
| GN 923-125-K12-A-* | 125 | 12           | 31 | 22   | 15   | 11   | 18 | 33   | 61   | 45.5 | 22                   | -                    | GN 184-20                      | 253 |
| GN 923-125-B14-A-* | 125 | 14           | 31 | 22   | 15   | 11   | 18 | 33   | 61   | 45.5 | 22                   | -                    | GN 184-20                      | 252 |
| GN 923-125-K14-A-* | 125 | 14           | 31 | 22   | 15   | 11   | 18 | 33   | 61   | 45.5 | 22                   | -                    | GN 184-20                      | 252 |
| GN 923-140-B14-A-* | 140 | 14           | 36 | 28.5 | 16.5 | 13   | 19 | 36   | 76   | 52   | 24                   | -                    | GN 184-25                      | 338 |
| GN 923-140-K14-A-* | 140 | 14           | 36 | 28.5 | 16.5 | 13   | 19 | 36   | 76   | 52   | 24                   | -                    | GN 184-25                      | 338 |
| GN 923-140-B16-A-* | 140 | 16           | 36 | 28.5 | 16.5 | 13   | 19 | 36   | 76   | 52   | 24                   | -                    | GN 184-25                      | 337 |
| GN 923-140-K16-A-* | 140 | 16           | 36 | 28.5 | 16.5 | 13   | 19 | 36   | 76   | 52   | 24                   | -                    | GN 184-25                      | 337 |
| GN 923-160-B14-A-* | 160 | 14           | 36 | 28.5 | 18   | 14.5 | 20 | 39   | 76   | 61   | 24                   | -                    | GN 184-25                      | 432 |
| GN 923-160-K14-A-* | 160 | 14           | 36 | 28.5 | 18   | 14.5 | 20 | 39   | 76   | 61   | 24                   | -                    | GN 184-25                      | 432 |
| GN 923-160-B16-A-* | 160 | 16           | 36 | 28.5 | 18   | 14.5 | 20 | 39   | 76   | 61   | 24                   | -                    | GN 184-25                      | 431 |
| GN 923-160-K16-A-* | 160 | 16           | 36 | 28.5 | 18   | 14.5 | 20 | 39   | 76   | 61   | 24                   | -                    | GN 184-25                      | 431 |
| GN 923-200-B18-A-* | 200 | 18           | 42 | 36   | 20.5 | 16   | 24 | 45   | 85   | 77.5 | 25                   | -                    | GN 184-32                      | 780 |
| GN 923-200-K18-A-* | 200 | 18           | 42 | 36   | 20.5 | 16   | 24 | 45   | 85   | 77.5 | 25                   | -                    | GN 184-32                      | 780 |
| GN 923-200-B20-A-* | 200 | 20           | 42 | 36   | 20.5 | 16   | 24 | 45   | 85   | 77.5 | 25                   | -                    | GN 184-32                      | 779 |
| GN 923-200-K20-A-* | 200 | 20           | 42 | 36   | 20.5 | 16   | 24 | 45   | 85   | 77.5 | 25                   | -                    | GN 184-32                      | 779 |

Gewicht SW



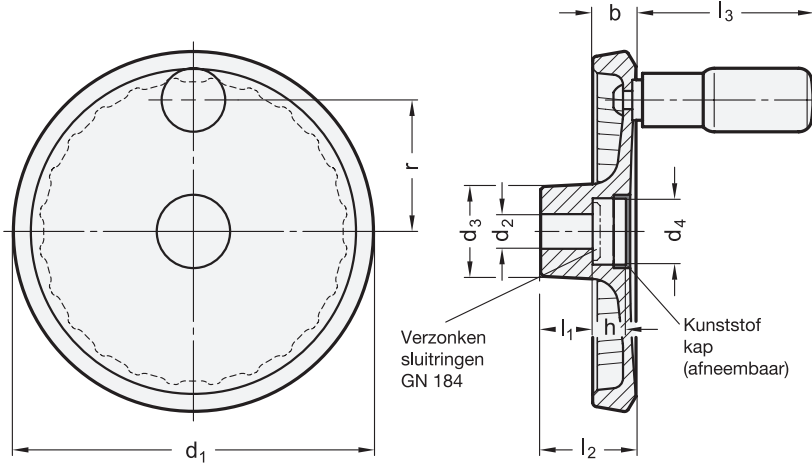

\* Compleet met kleurindex van de Schijfhandwielen (SW or SR)

SW RAL9005 SR RAL9006

GN 923-R

| Beschrijving       | d1  | d2 H7 Boring | d3 | d4   | b    | h    | l1 | l2 ≈ | l3 ≈ | r    | Ø Handgreep GN 798.2 | Ø Handgreep GN 599.5 | aanbevolen verzonken sluitring | ⚖   |
|--------------------|-----|--------------|----|------|------|------|----|------|------|------|----------------------|----------------------|--------------------------------|-----|
| GN 923-50-B6-R-*   | 50  | 6            | 20 | 13   | 13   | 7    | 16 | 26   | 20   | 16   | -                    | 13                   | GN 184-12                      | 77  |
| GN 923-50-K6-R-*   | 50  | 6            | 20 | 13   | 13   | 7    | 16 | 26   | 20   | 16   | -                    | 13                   | GN 184-12                      | 77  |
| GN 923-50-B8-R-*   | 50  | 8            | 20 | 13   | 13   | 7    | 16 | 26   | 20   | 16   | -                    | 13                   | GN 184-12                      | 76  |
| GN 923-50-K8-R-*   | 50  | 8            | 20 | 13   | 13   | 7    | 16 | 26   | 20   | 16   | -                    | 13                   | GN 184-12                      | 76  |
| GN 923-63-B8-R-*   | 63  | 8            | 23 | 17   | 13   | 7    | 16 | 26   | 20   | 20,5 | -                    | 13                   | GN 184-16                      | 115 |
| GN 923-63-K8-R-*   | 63  | 8            | 23 | 17   | 13   | 7    | 16 | 26   | 20   | 20,5 | -                    | 13                   | GN 184-16                      | 115 |
| GN 923-63-B10-R-*  | 63  | 10           | 23 | 17   | 13   | 7    | 16 | 26   | 20   | 20,5 | -                    | 13                   | GN 184-16                      | 113 |
| GN 923-63-K10-R-*  | 63  | 10           | 23 | 17   | 13   | 7    | 16 | 26   | 20   | 20,5 | -                    | 13                   | GN 184-16                      | 113 |
| GN 923-80-B10-R-*  | 80  | 10           | 26 | 17   | 13   | 7    | 16 | 26   | 43,5 | 27,5 | 16                   | -                    | GN 184-16                      | 120 |
| GN 923-80-K10-R-*  | 80  | 10           | 26 | 17   | 13   | 7    | 16 | 26   | 43,5 | 27,5 | 16                   | -                    | GN 184-16                      | 120 |
| GN 923-80-B12-R-*  | 80  | 12           | 26 | 17   | 13   | 7    | 16 | 26   | 43,5 | 27,5 | 16                   | -                    | GN 184-16                      | 100 |
| GN 923-80-K12-R-*  | 80  | 12           | 26 | 17   | 13   | 7    | 16 | 26   | 43,5 | 27,5 | 16                   | -                    | GN 184-16                      | 100 |
| GN 923-100-B10-R-* | 100 | 10           | 28 | 22   | 14   | 9,5  | 17 | 30   | 58   | 36   | 18                   | -                    | GN 184-20                      | 186 |
| GN 923-100-K10-R-* | 100 | 10           | 28 | 22   | 14   | 9,5  | 17 | 30   | 58   | 36   | 18                   | -                    | GN 184-20                      | 186 |
| GN 923-100-B12-R-* | 100 | 12           | 28 | 22   | 14   | 9,5  | 17 | 30   | 58   | 36   | 18                   | -                    | GN 184-20                      | 180 |
| GN 923-100-K12-R-* | 100 | 12           | 28 | 22   | 14   | 9,5  | 17 | 30   | 58   | 36   | 18                   | -                    | GN 184-20                      | 180 |
| GN 923-125-B12-R-* | 125 | 12           | 31 | 22   | 15   | 11   | 18 | 33   | 61   | 45,5 | 22                   | -                    | GN 184-20                      | 340 |
| GN 923-125-K12-R-* | 125 | 12           | 31 | 22   | 15   | 11   | 18 | 33   | 61   | 45,5 | 22                   | -                    | GN 184-20                      | 340 |
| GN 923-125-B14-R-* | 125 | 14           | 31 | 22   | 15   | 11   | 18 | 33   | 61   | 45,5 | 22                   | -                    | GN 184-20                      | 339 |
| GN 923-125-K14-R-* | 125 | 14           | 31 | 22   | 15   | 11   | 18 | 33   | 61   | 45,5 | 22                   | -                    | GN 184-20                      | 339 |
| GN 923-140-B14-R-* | 140 | 14           | 36 | 28,5 | 16,5 | 13   | 19 | 36   | 76   | 52   | 24                   | -                    | GN 184-25                      | 420 |
| GN 923-140-K14-R-* | 140 | 14           | 36 | 28,5 | 16,5 | 13   | 19 | 36   | 76   | 52   | 24                   | -                    | GN 184-25                      | 420 |
| GN 923-140-B16-R-* | 140 | 16           | 36 | 28,5 | 16,5 | 13   | 19 | 36   | 76   | 52   | 24                   | -                    | GN 184-25                      | 382 |
| GN 923-140-K16-R-* | 140 | 16           | 36 | 28,5 | 16,5 | 13   | 19 | 36   | 76   | 52   | 24                   | -                    | GN 184-25                      | 382 |
| GN 923-160-B14-R-* | 160 | 14           | 36 | 28,5 | 18   | 14,5 | 20 | 39   | 76   | 61   | 24                   | -                    | GN 184-25                      | 543 |
| GN 923-160-K14-R-* | 160 | 14           | 36 | 28,5 | 18   | 14,5 | 20 | 39   | 76   | 61   | 24                   | -                    | GN 184-25                      | 543 |
| GN 923-160-B16-R-* | 160 | 16           | 36 | 28,5 | 18   | 14,5 | 20 | 39   | 76   | 61   | 24                   | -                    | GN 184-25                      | 541 |
| GN 923-160-K16-R-* | 160 | 16           | 36 | 28,5 | 18   | 14,5 | 20 | 39   | 76   | 61   | 24                   | -                    | GN 184-25                      | 541 |
| GN 923-200-B18-R-* | 200 | 18           | 42 | 36   | 20,5 | 16   | 24 | 45   | 85   | 77,5 | 25                   | -                    | GN 184-32                      | 880 |
| GN 923-200-K18-R-* | 200 | 18           | 42 | 36   | 20,5 | 16   | 24 | 45   | 85   | 77,5 | 25                   | -                    | GN 184-32                      | 880 |
| GN 923-200-B20-R-* | 200 | 20           | 42 | 36   | 20,5 | 16   | 24 | 45   | 85   | 77,5 | 25                   | -                    | GN 184-32                      | 878 |
| GN 923-200-K20-R-* | 200 | 20           | 42 | 36   | 20,5 | 16   | 24 | 45   | 85   | 77,5 | 25                   | -                    | GN 184-32                      | 878 |

Gewicht SW

Handwielen, handslingers